



## Measuring Guide

### STEP ONE

- Use the graph paper on the Page 2 to sketch the shape of the room you are buying cabinets for. Be sure to have a line for each wall, door, and window. (Most kitchens will either be a U, L or single wall galley shape with a peninsula or island).

### STEP TWO

- First, measure from the floor to the ceiling to determine the maximum cabinet height that can be used. You can record all measurements on Page 3.

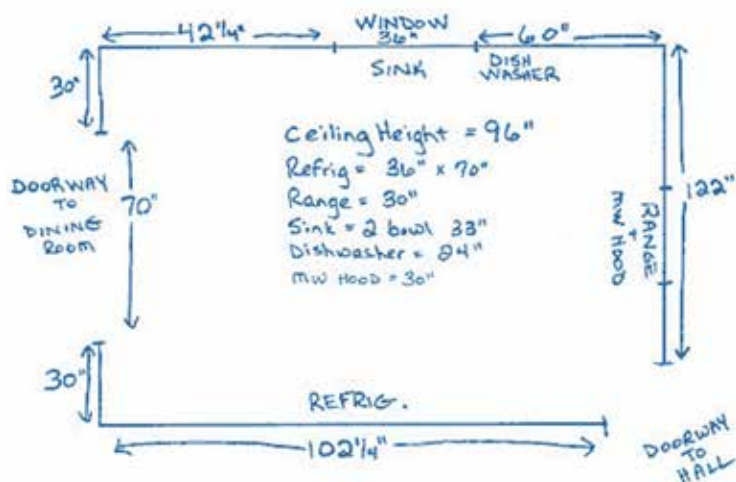

### STEP THREE

- Next you'll need to record the measurement of every wall section on the drawing and Page 3. (A section is considered to be from a corner to a door way or window trim or opening.)

### STEP FOUR

- Once the wall sections are recorded, measure each door and window from outside edge to outside edge of casing or trim. Remember to Indicate on your sketch how each door swings.

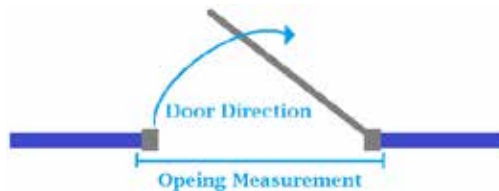

### STEP FIVE

- The sink's precise location along with other water and gas lines need to be marked on the drawing and Page 3 by indicating where the CENTER of these lines are, not edges.

### STEP SIX

- Be sure to mark the locations and dimensions of all the appliances will go. (You will need the Width, Height, and Depth of each).

### STEP SEVEN

- To make sure your cabinets will fit your space, always DOUBLE CHECK YOUR WORK! You can add up all the dimensions of the wall sections, windows, and appliances to be sure it is equal to the total wall measurements. Re-measure where needed!



CABINETCORP™

This form can be uploaded to our designers at  
[www.cabinetcorp.com/kitchen-design-services](http://www.cabinetcorp.com/kitchen-design-services) Or  
emailed to [design@cabinetcorp.com](mailto:design@cabinetcorp.com).  
If you have any questions, please call: 678-695-7070

## Sketch

Customer Name: \_\_\_\_\_ Customer Email: \_\_\_\_\_  
Customer Phone: \_\_\_\_\_ Customer Project: \_\_\_\_\_

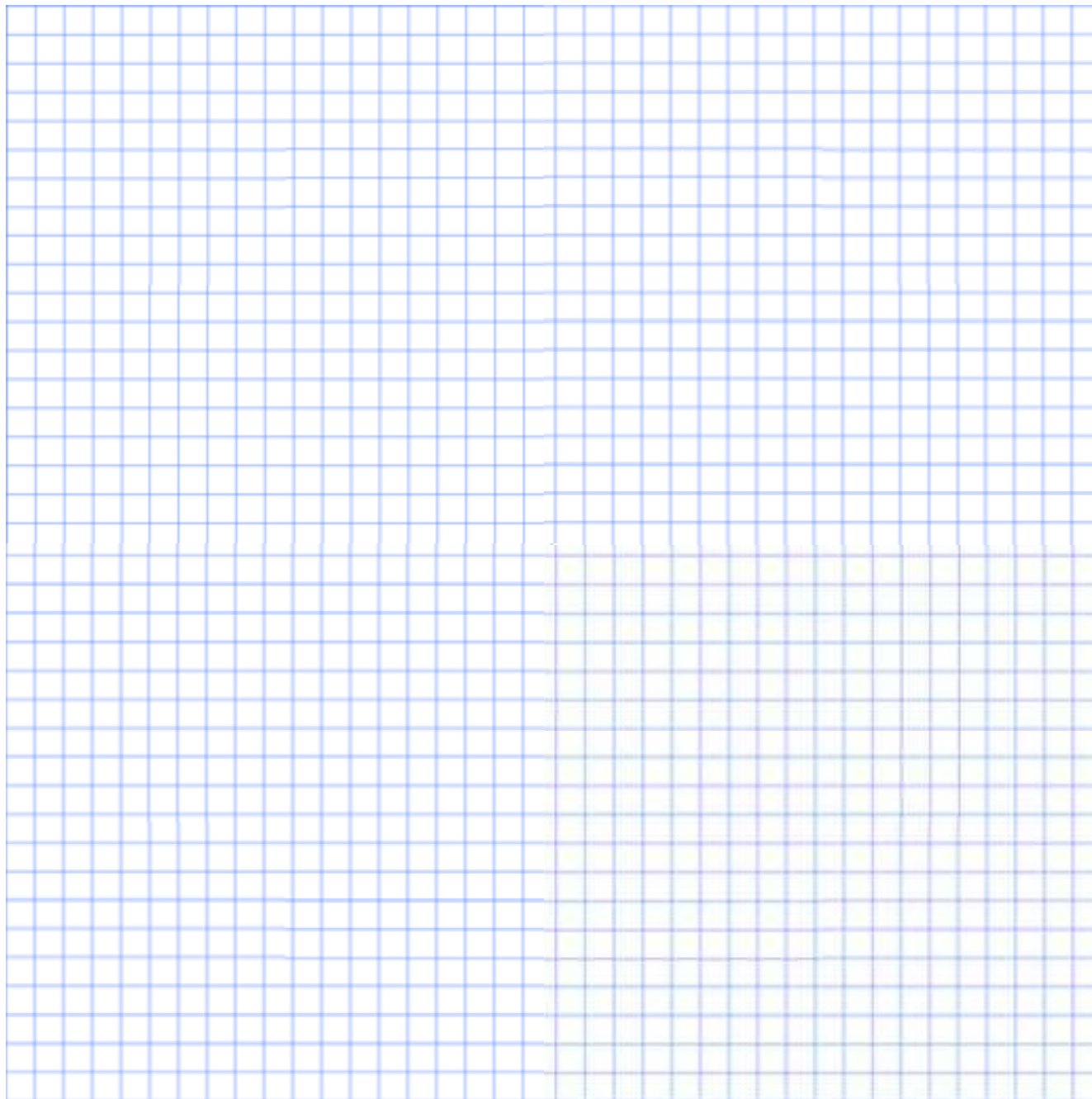



CABINETCORP™

This form can be uploaded to our designers at  
www.cabinetcorp.com/kitchen-design-services Or  
emailed to design@cabinetcorp.com.  
If you have any questions, please call: 678-695-7070

## Measurements

Fill out all that apply and print additional copies if more space is needed

### KEY TERMS

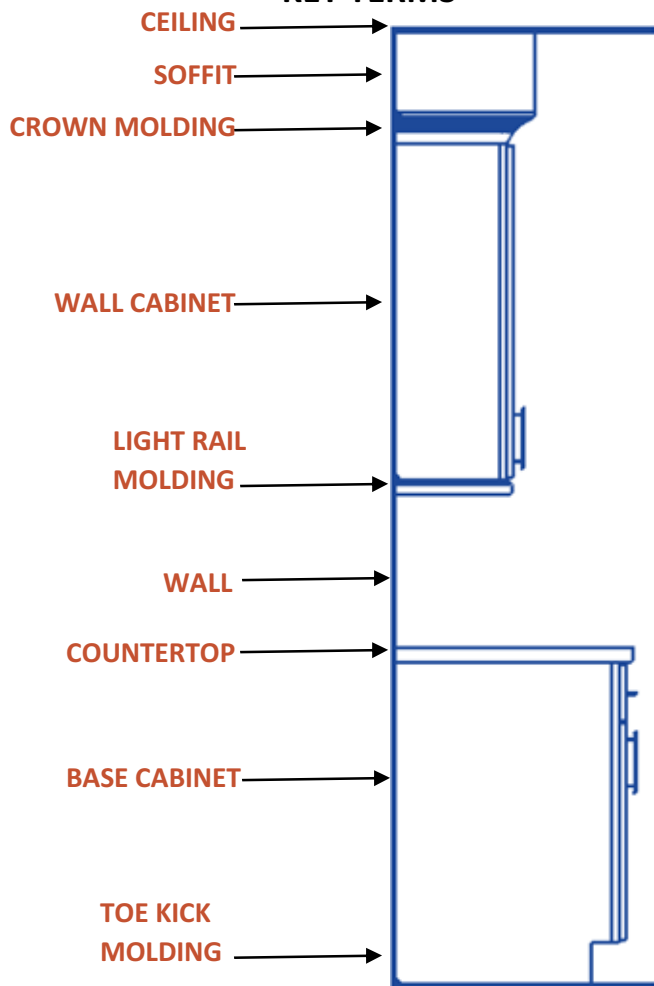

### YOUR STYLE:

Main Door Style: \_\_\_\_\_

Accent Door Style: \_\_\_\_\_

Limitations (plumbing, electric, flooring, etc):  
\_\_\_\_\_  
\_\_\_\_\_

MUST HAVE (spice storage, microwave cabinet, etc):  
\_\_\_\_\_  
\_\_\_\_\_

WOULD LIKE (wine rack, glass doors, crown, etc):  
\_\_\_\_\_  
\_\_\_\_\_

Ceiling Height: \_\_\_\_\_

Wall Cabinet Height (if applicable): \_\_\_\_\_

Soffit Height (if applicable): \_\_\_\_\_

Soffit Depth (if applicable): \_\_\_\_\_

Wall Widths: \_\_\_\_\_

Section A: \_\_\_\_\_

Section B: \_\_\_\_\_

Section C: \_\_\_\_\_

Section D: \_\_\_\_\_

Section E: \_\_\_\_\_

### Doorway/Window Opening Widths:

Opening 1: \_\_\_\_\_

Opening 2: \_\_\_\_\_

Opening 3: \_\_\_\_\_

Opening 4: \_\_\_\_\_

Opening 5: \_\_\_\_\_

### Appliances:

#### Refrigerator:

Height: \_\_\_\_\_ Width: \_\_\_\_\_ Depth: \_\_\_\_\_

#### Oven:

Height: \_\_\_\_\_ Width: \_\_\_\_\_ Depth: \_\_\_\_\_

Center Gas Line: \_\_\_\_\_

#### Stovetop:

Height: \_\_\_\_\_ Width: \_\_\_\_\_ Depth: \_\_\_\_\_

Center Gas Line from Section Edge: \_\_\_\_\_

#### Hood:

Height: \_\_\_\_\_ Width: \_\_\_\_\_ Depth: \_\_\_\_\_

#### Dishwasher:

Height: \_\_\_\_\_ Width: \_\_\_\_\_ Depth: \_\_\_\_\_

#### Other:

Height: \_\_\_\_\_ Width: \_\_\_\_\_ Depth: \_\_\_\_\_

### Sink:

Height: \_\_\_\_\_ Width: \_\_\_\_\_ Depth: \_\_\_\_\_

Center Water Line from Section Edge: \_\_\_\_\_

### Exposed Outlets:

Center from Section A Edge: \_\_\_\_\_

Center from Section B Edge: \_\_\_\_\_

Center from Section C Edge: \_\_\_\_\_

Center from Section D Edge: \_\_\_\_\_

Customer Name: \_\_\_\_\_

# Standard Sizes and Dimensions

## Base Cabinet Dimensions

Standard Cabinet Height	34.5-inches (36 inches with countertop)
Standard Cabinet Depth	21 or 24 inches; depth for a cabinet with a Lazy Susan is 33-inches.
Standard Cabinet Width	12, 15, 18, 21, 24, 26.25, 27, 30, 33, 36, 39 and 42-inches. Filler cabinets come in 6 and 9 inch widths.

Standard cabinet height for base cabinets is almost invariably 34.5 inches. While that may be too low for really tall individuals who shouldn't have to stoop to use their kitchen surfaces, this base height can be easily increased by adding a countertop underlay or choosing a thicker countertop. An inch or an inch and a half can make a huge difference in cabinet size and installation.

Base cabinets are rarely more than 24 inches deep, for a good reason. Anything deeper makes items stored at the back of the cabinets almost impossible to access without pull-out fittings.

Base cabinets are the workhorses of any kitchen. They support countertops, surround, dishwashers and sinks, and allow for cutlery drawers. Base cabinets vary much more in width than in-depth or height. Available in 3-inch increments, in widths that range from 9-inch to 48-inch widths. Base cabinets are the most customizable standard kitchen cabinets and will help you make the best use of the dead space in the kitchen.

## Kitchen Wall Cabinets Sizes

Standard Cabinet Height	30, 36, or 42-inches based on your preferences and ceiling height.
Standard Cabinet Depth	12 or 24-inches.
Standard Cabinet Width	12, 15, 18, 24, 27, 30, 33, and 36-inches. Filler cabinets come in 3, 6, 9-inches.

Upper cabinet height will vary based on both space available and aesthetics. Since they need to be positioned 18 inches above the countertops, choosing kitchen wall cabinets is a decision to be made after selecting both base cabinets, countertops, and filler layer (if any).

Wall cabinets supply the kitchen equivalent of a home's exterior "curb appeal." They are easily accessorized. Glass inserts, interior lighting, contrasting cabinet fronts, and, of course, luxurious or whimsical cabinet knobs or magnetic cabinet latches are just a few of the ways standard kitchen wall cabinets can be customized. Some homeowners want crown moldings and display space above their kitchen wall cabinets; others want the wall cabinets to go right to the ceiling so everything can be neatly contained.

Upper cabinet heights include 12-inch, 15-inch, 18-inch, 24-inch, 30-inch, 36-inch, and 42-inch options, with shorter cabinets above fridges and stoves. Standard depths are 12, 15, 18, 24 inches, but 12 inches is the most common depth for regular wall cabinets used to store food and dishes. This depth allows sufficient space beneath the cabinets to make countertops ranging in depth from 24 to 26 inches usable.

Over-fridge cabinets are usually 24 inches deep, while 15- to 18-inch wall cabinets tend to be used over microwaves. Like base cabinets, standard wall cabinets come in widths ranging from 9 to 48 inches in 3-inch increments. There are, however, few kitchens that can accommodate 48-inch-wide wall cabinets.

## Tall Cabinet Dimensions

Standard Cabinet Height	84, 90, 96 inches.
Standard Cabinet Depth	24 inches.
Standard Cabinet Width	18, 24, 30, 33 inches.

Tall pantry or utility cabinets are often the roomiest of kitchen cabinetry. Standard tall cabinets are 12 or 24 inches deep and come in 12-inch, 24-inch, or 36-inch widths. They range in height from 84 to 96 inches (with 96 inches being a floor-to-ceiling cabinet in a room with standard 8-foot ceilings),

Pantry cabinets are usually 12 inches deep, while those used as utility cabinets tend to be 24 inches to accommodate brooms, mops, vacuums, and other floor-cleaning appliances.

Narrow pantry cabinets (in a 12-inch width) with the right storage fixtures hold a surprising amount of food. However, if the homeowner wants pull-outs or storage installed on the back of the cabinet doors and inside the cabinet, 36-inch-wide tall cabinets are recommended. Most of the time, 24-inch-wide tall cabinets work well for both pantry and utility cabinets.